

Installing the Quick Clamps

1. Install the proper length threaded rod (bolt) for your vehicle in your clamps. The clamps come standard with 80mm length bolts installed, but optional 50mm, 65mm and 100mm bolts are provided for accommodating various roof rack sizes.

2. If necessary, use the supplied hex key to remove and replace the bolt for your desired fit.

3. For installation, slide the t-nut of the clamp into the desired t-nut slot on the CRC System's aluminum sections, as shown below. Repeat for second clamp.

4. Install the clamp arm around your vehicle's crossbar.

5. Install the pivot piece, lock washer, and security nut as shown above. Repeat for second clamp.

6. Use the supplied security wrench to tighten the security nut by turning clockwise until secure. Do NOT over tighten. Repeat process for the second clamp.

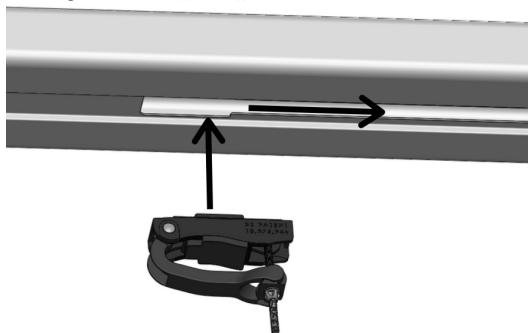

Trxstle

INSPECTION AND PACKAGING CHECKLIST

- Rod liners inspected for durability and telescopic function
- Aluminum tubes inspected for smooth telescoping action and positive locking
- Locks and latches inspected for function and keys matched
- Unit is free of cosmetic scratches and/or blemishes

Final quality control inspection done by:

WARRANTY REGISTRATION

Visit Trxstle.com/crc-registration-form and complete the form to register your CRC System for our limited lifetime warranty.

Your serial number can be found inside the reel housing and will read something like: CRC00XXXX. Please locate your serial number and record it below for quick and easy access.

Serial Number:

CRC SYSTEM

USER MANUAL

Limited lifetime warranty information can be found on the back of this manual.

Have a question? Give us a call or email us - we are always happy to help!

Phone
(360) 481-8216

Email
support@trxstle.com

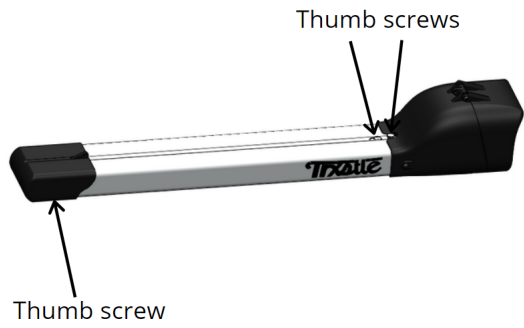

Extending the CRC System

1. Remove the security thumb screws from all three button locations (shown above).
2. Press down on the nose piece button 1 (shown below) and pull the plastic nose piece out until the first aluminum section clicks into place and the STOP label shows on the top of the CRC System. This is 1/2 length.

Depress button 1



3. Press button 3 and extend the tube until the STOP label is shown and it clicks into place. This is 3/4 length.
4. Press button 4 and extend the final tube until the STOP label is shown and it clicks into place. This is full length.
5. (Optional) Install thumb screws in button tops to prevent buttons from being depressed while mounted.

Depress Button 3

Depress Button 4

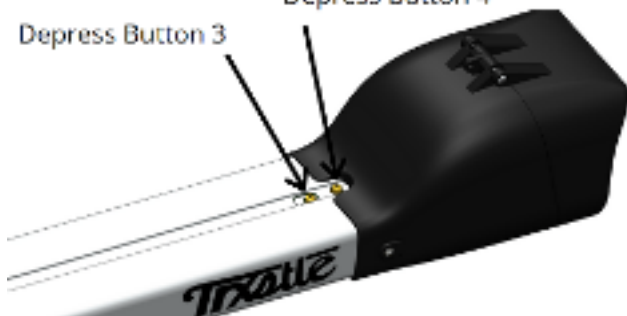

Extending Order

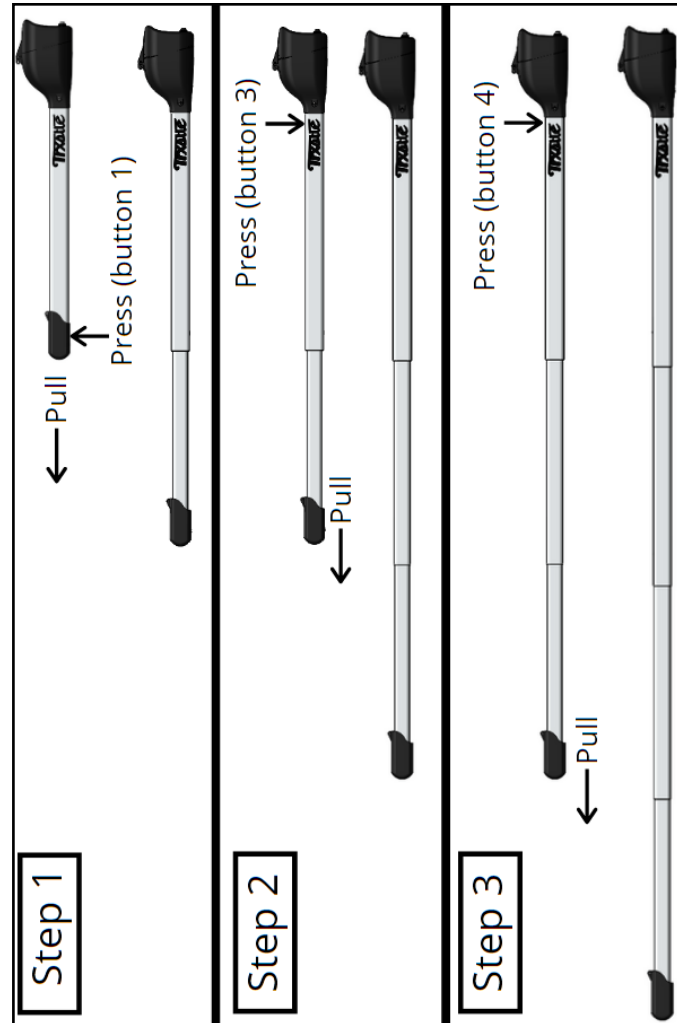

Fun Facts

1. Make sure your fly rods are removed from the CRC before collapsing
2. Thumb screws and clamps must be removed before telescoping the CRC System.
3. The CRC System can be mounted in any length configuration. Please follow guidelines at Trxstle.com for rack fitment and recommended configuration.

Collapsing the CRC System

1. To collapse the CRC System, start at the forward most aluminum section (furthest from the reel housing), depress button 2 and collapse the smallest aluminum section.
2. Depress button 3 and collapse the forward sections into the next largest aluminum section.
3. Depress button 4 and collapse all forward aluminum sections into the final largest aluminum section. Ensure buttons 3 and 4 return to their original home position on top of the CRC System.
4. Install thumb screws on the three exposed buttons.

Collapsing Order

