

# THE GERYON UNIVERSAL BIKE PACKING SYSTEM

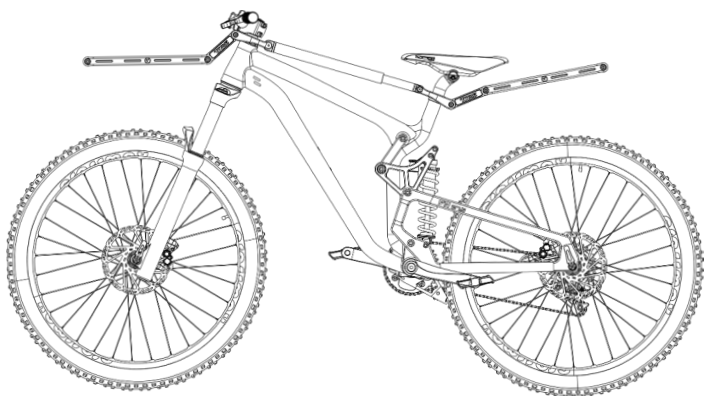

## INSTALLATION GUIDE & USER MANUAL



# PREPARATION

---

You will need some basic tools and knowledge of bicycle mechanics to properly install the Geryon Universal Bike Packing System. If you are not comfortable with working on your own bicycle, a qualified bicycle mechanic can assist with the installation of the Geryon Universal Bike Packing System.

Before you begin installation, make sure your bicycle is compatible with the Geryon. The Geryon is compatible with threadless 1 1/8" diameter fork steerers and seatposts in 27.2mm, 30.9mm and 31.6mm diameters (seatpost clamp spacers are provided for each size).

# TOOLS REQUIRED

---

- 4mm hex key
- Correct hex keys for your headset top cap bolt and stem steerer clamp bolts
- A torque wrench is recommended to prevent under or over tightening the bolts on your bicycle and the Geryon.
- Your favorite beverage (to stay hydrated and stuff)



4MM HEX KEY



HEADSET HEX KEY

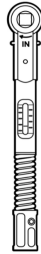

TORQUE WRENCH



BEVERAGE (OR TWO)



**LIKE VIDEOS MORE THAN READING?  
SCAN THE QR CODE TO WATCH THE  
INSTALLATION VIDEO!**

# PARTS & TERMS

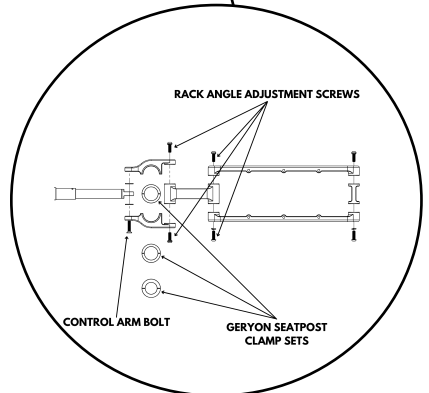
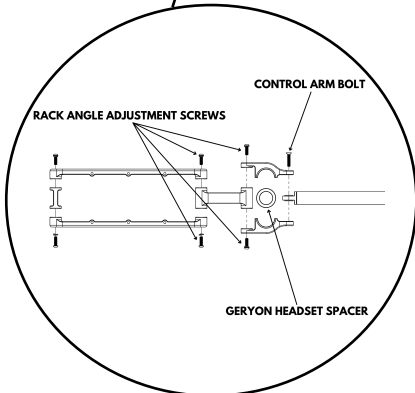
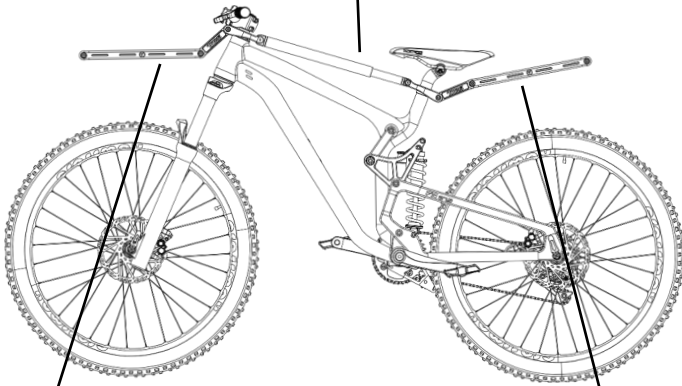
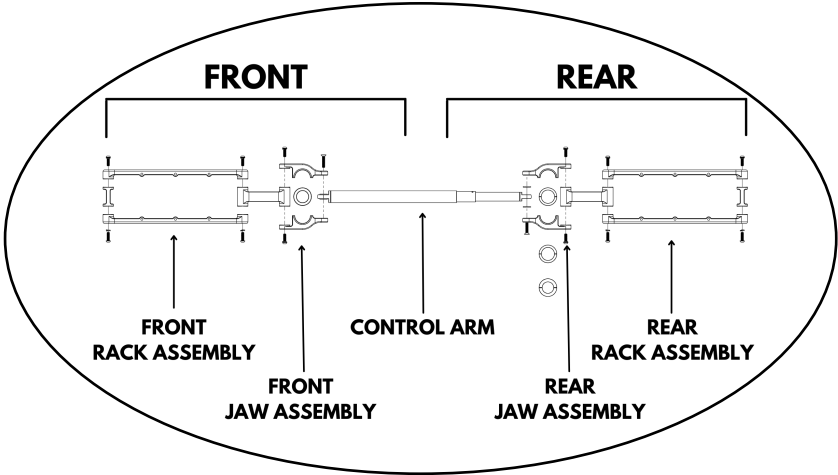

# INSTALLATION

## Remove your stem and handlebars

1. Loosen and remove the top cap bolt and top cap.

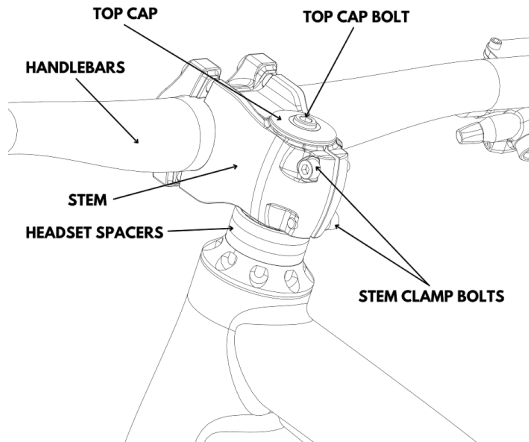

2. Loosen the stem clamp bolts on your bicycle and slide the stem and handlebar off the steerer.

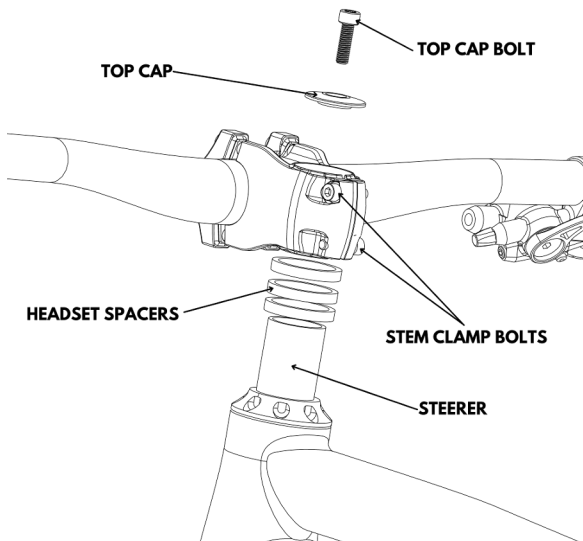

# Installing the Geryon headset spacer

1. Remove any existing headset spacers from the steerer.

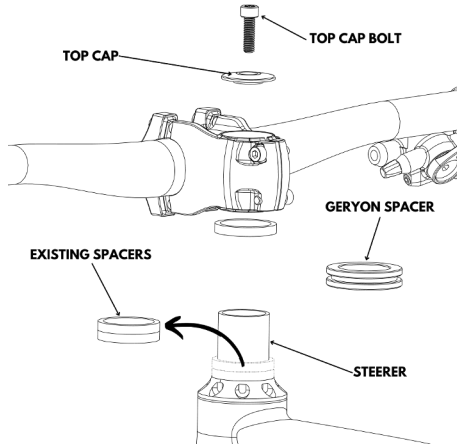

2. Add the custom Geryon headset spacer.

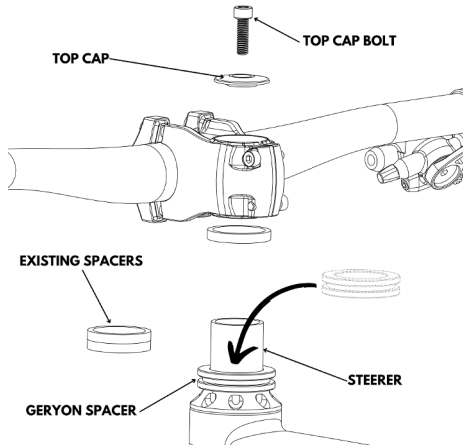

3. In almost all cases it will be necessary to remove existing spacers from your bicycle to make room for the custom Geryon spacer. The height of the spacers you remove should be similar in height to the Geryon spacer.



4. Slide your stem onto your fork steerer.

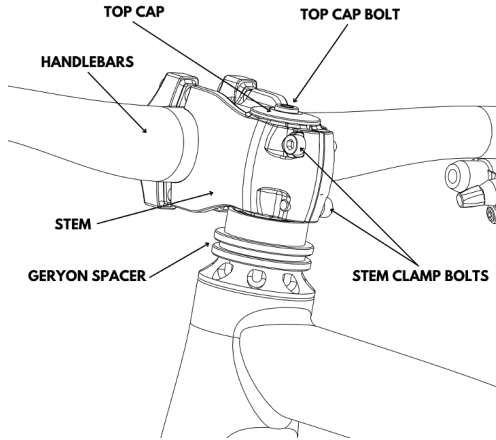

5. Reinstall and torque your top cap bolt to the bicycle manufacturer's recommended torque setting.

6. Align your handlebars with your front wheel and torque the stem clamp bolts to the bicycle manufacturer's recommended torque setting.

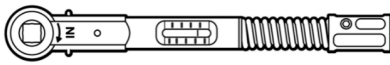

**IT'S TORQUE  
WRENCH TIME!**

## **Installing the front portion of the Geryon**

---

1. Remove the threaded jaw from the front portion of the Geryon as shown by loosening the control arm bolt and rack angle adjustment screw and set it aside someplace safe.

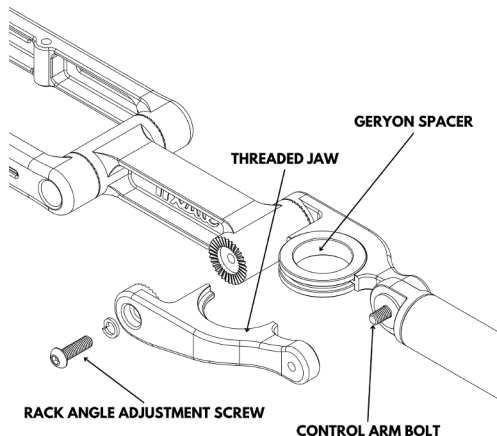

2. Attach the front half of the Geryon to the headset spacer that is installed on your fork steerer.

2a. Fit the front half of the Geryon around the installed spacer on the steerer.

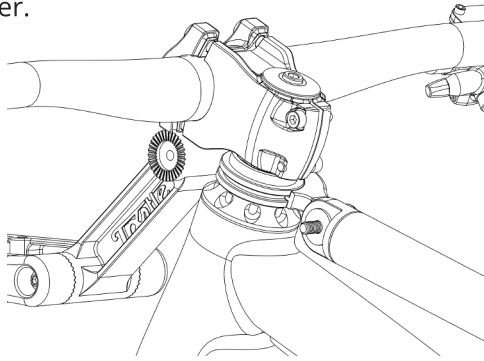

3. Install the threaded jaw piece by fitting around the other side of the installed steerer spacer.

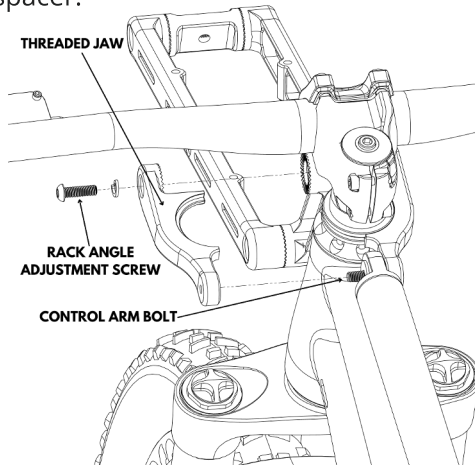

4. Tighten the two rack arm bolts on each side of the jaw assembly to 7 Nm (62 in lbs).

4a. Tighten the control arm bolt to 7 Nm (62 in lbs)

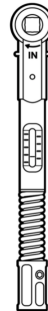
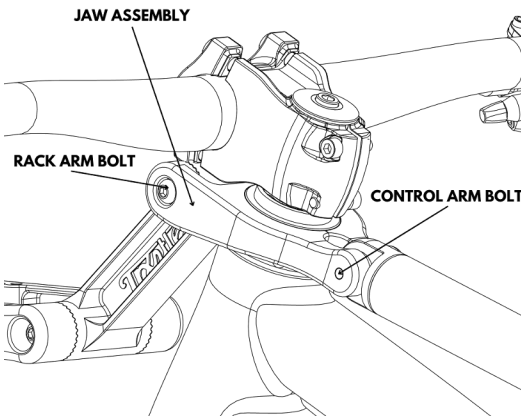

**IT'S TORQUE  
WRENCH TIME!**

5. Check the clearance between your stem and the Geryon front jaw assembly. Make sure they don't collide or rub.

\*If a collision or rubbing occurs, you will need to install an additional spacer on your steerer and repeat the front rack installation procedures.

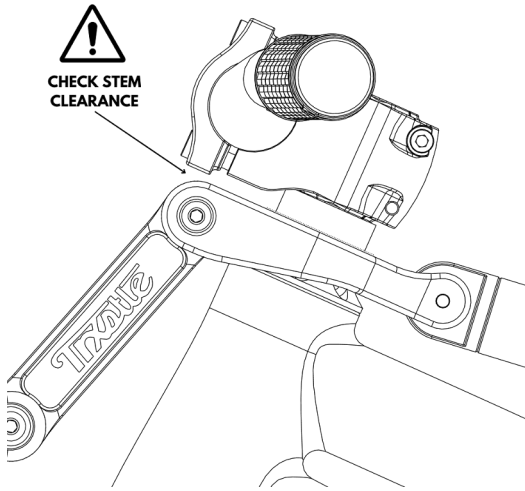

6. The front of your bike should now look like this...

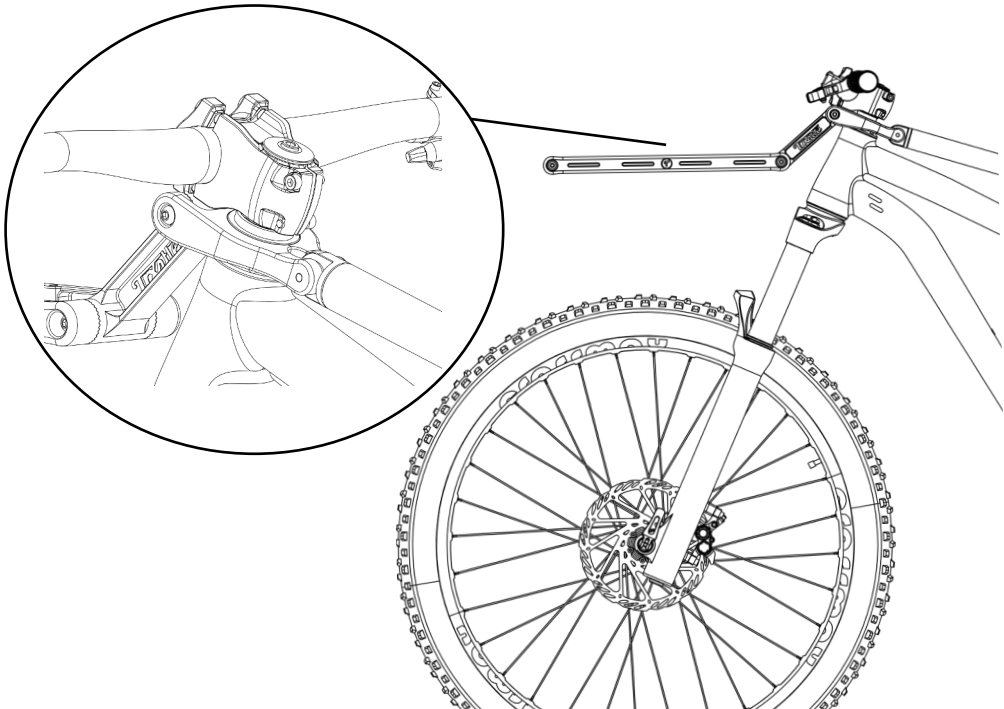



# Installing the rear portion of the Geryon

1. The Geryon comes with three standard seatpost spacer sets, **27.2**, **30.9** and **31.6mm**.

The spacer sets are designed to fit around the matching seatpost size. If you don't know your seatpost size you can find it stamped on the bottom of the seatpost or listed on the bicycle manufacturer's website.

If your seatpost is not one of these three most common sizes, **27.2**, **30.9**, **31.6**, please see the notes section on the back cover.

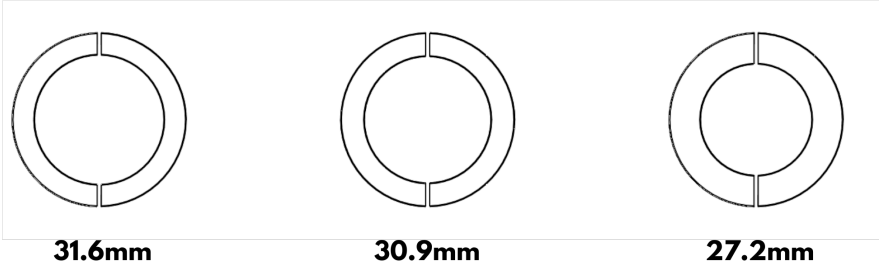

2. Place the appropriate Geryon seatpost clamp set on your seatpost as shown below

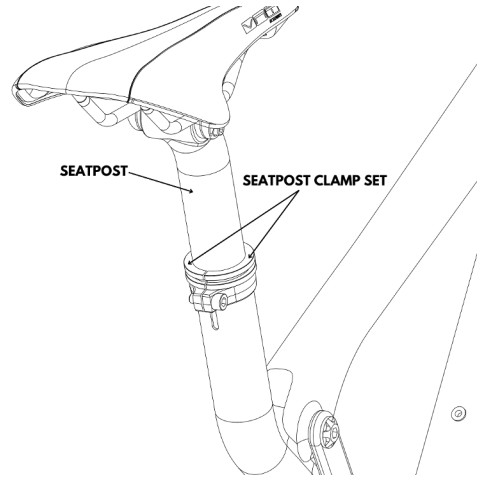
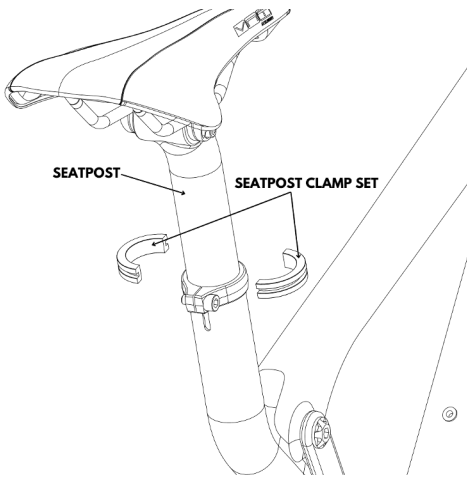

3. Remove the threaded jaw from the rear portion of the Geryon as shown by loosening the control arm bolt and rack angle adjustment screw (hint: it's just like the front one)

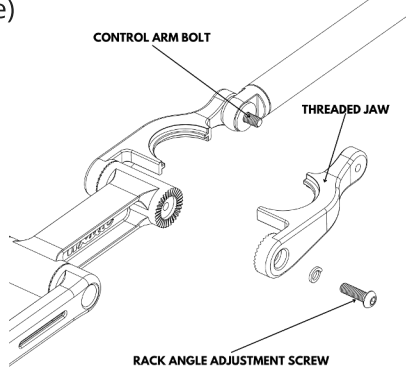

4. Insert the rear rack section into the front rack section.

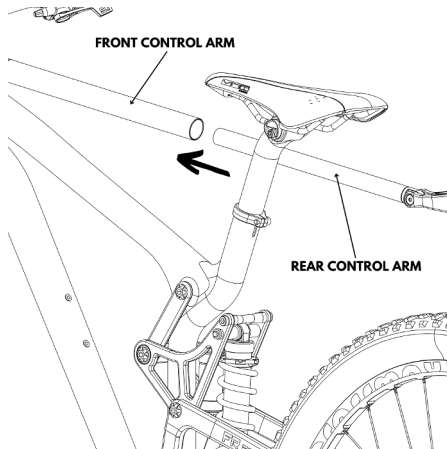

5. Fit the disassembled rear section's jaw onto the seatpost spacers and reinstall the threaded jaw half that was removed.

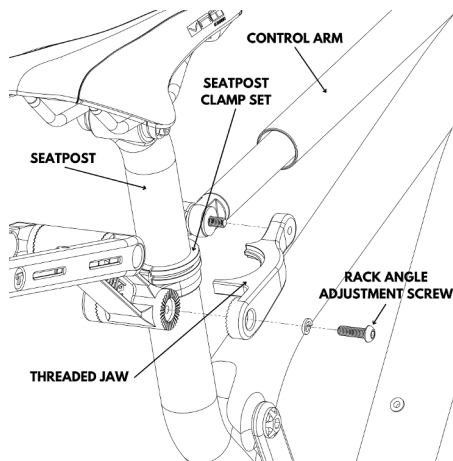

6. ~~Turn~~ Torque the two rack angle adjustment screws to 7 Nm (62 in-lbs)

6a. Torque the single control arm bolt to 7 Nm (62 in-lbs)

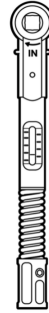
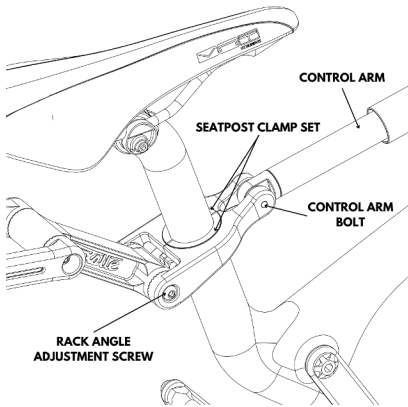

**IT'S TORQUE  
WRENCH TIME!**

7. Your bike should now look something like this...

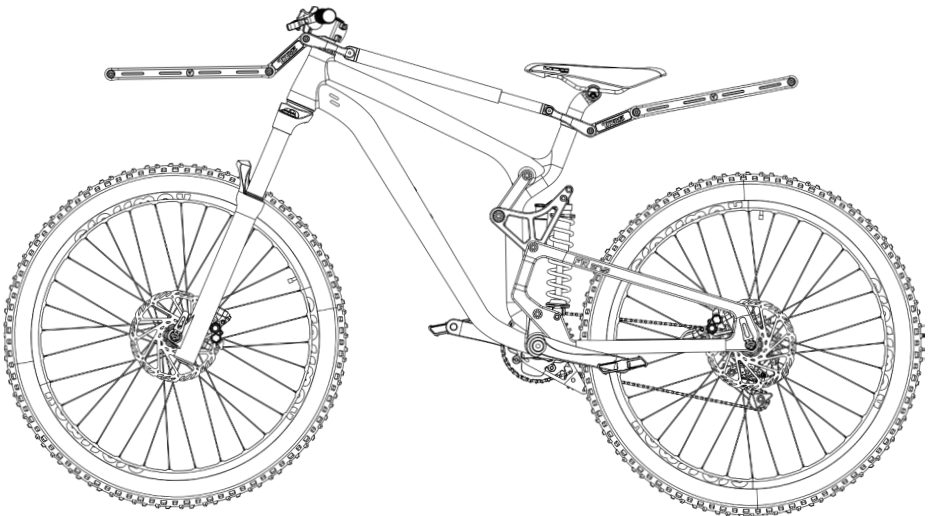

# Rack Angle Adjustment

---

1. Loosen the rack angle adjustment screws on both sides of the appropriate joint to adjust the angle.

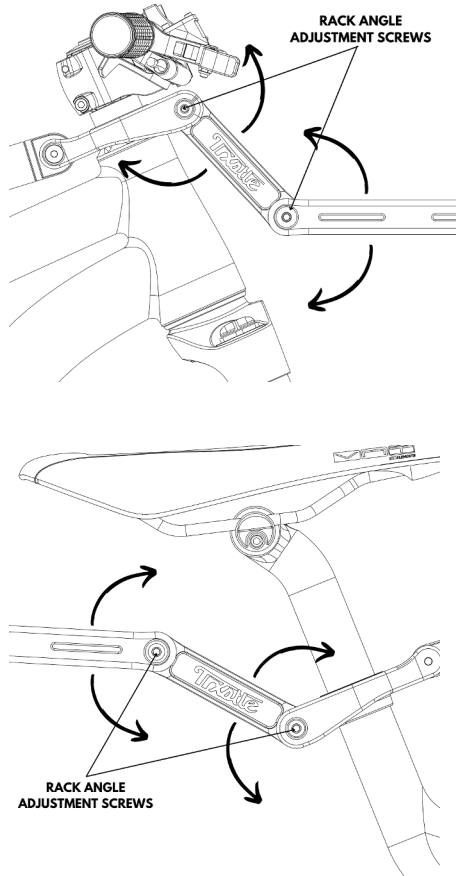

2. Ensure all bolts are torqued to 7 Nm (62 in-lbs) after adjustment

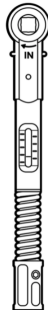

**IT'S TORQUE  
WRENCH TIME!**

# Mounting Your Stuff To The Geryon

---

1. Strap slots: each rack has 8 strap slots which let you use our 12in Cinch Straps (included) or 6ft Utility Straps (sold separate) to lash gear down however you like.

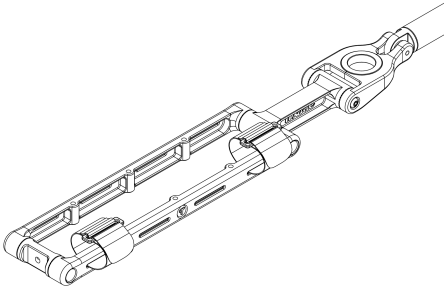

**CINCH STRAPS (4 INCLUDED)**

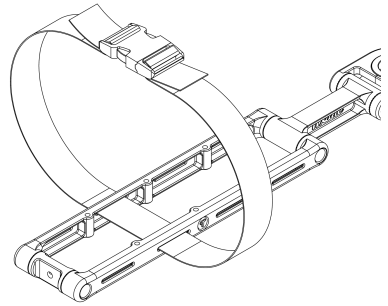

**UTILITY STRAPS (SOLD SEPARATE)**

2. There are 6 bolt holes on each rack. These are M6 threaded holes and they work great with accessories like our gear wrap and utility deck. They're tapped all the way through so you can bolt things to the top or the bottom. We know you like options.

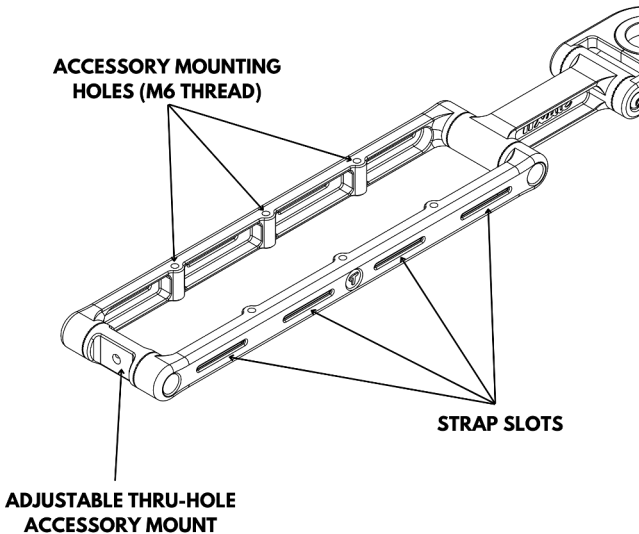

3. The front spacer on the Geryon works just like all the other adjustment points. It can be loosened and pivoted around as needed and has a through-hole for bolting stuff onto it. We recommend a 1/4" standard bolt or an M6 metric bolt.

## Optional Utility Deck Installation (Sold Separately)

---

1. Install the Utility Deck (sold separately) by using the two included flat head screws

1a. Line up with notches (image below)

1b. Align the screw holes with one of the three available locations on the front OR rear rack (show screw locations and label)

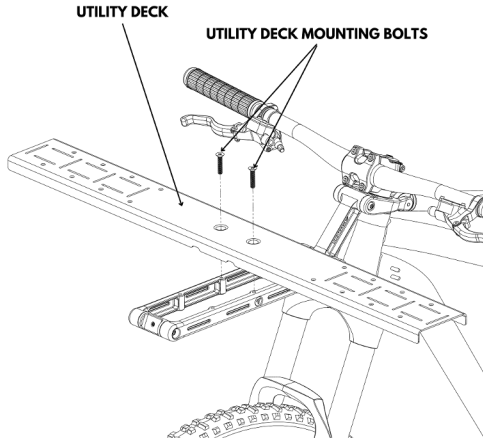

2. The utility deck can be mounted on either the front or rear section of the Geryon

3. The Utility Deck is equipped with:

3a. Strap slots (Utility straps sold separately)

3b. Holes for Kolpin mounts (sold separately)

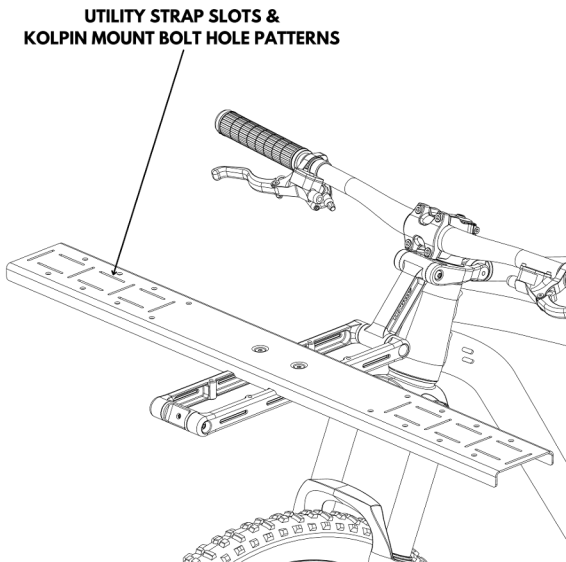

# Optional Utility Deck Configurations & Specs

---

1. Strap slots: each rack has 8 strap slots which let you use our 12in Cinch Straps (included) or 6ft Utility Straps (sold separate) to lash gear down however you like.

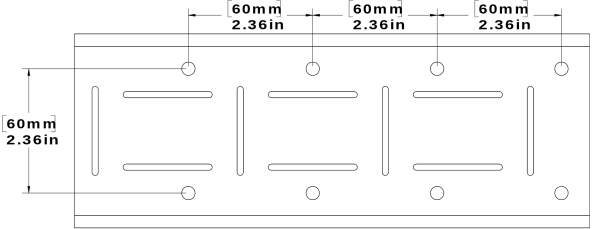

**MOUNTING HOLES SPACING**

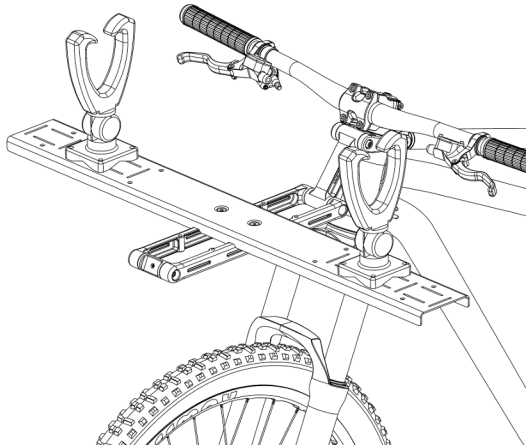

**MOUNTING OPTIONS (ACCESSORIES SOLD SEPARATELY)**

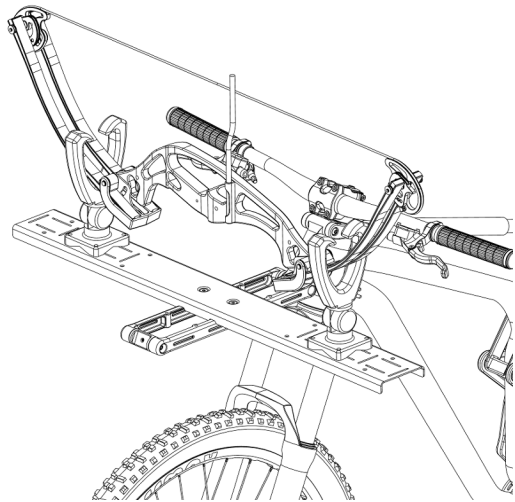



## Important Notes

---

The Geryon Universal Bike Packing System is not compatible with quill style stems and threaded steerer tubes.

The Geryon's headset spacer is designed to fit on standard 1 1/8" steerer tubes. Do not install or use the Geryon spacer on older 1" diameter threadless steerers.

The Geryon comes with 27.2, 30.9 and 31.6mm seatpost spacers which fit the majority of bicycle seatposts on the market. If your seatpost is a different size you will need to: Purchase a new seatpost in one of the standard sizes and install it using a seatpost shim (sold separately, Trxstle does not sell seatposts etc...) -OR- use a shim around your existing seatpost to match the size of the Geryon adapters.

## Get In Touch

---

360-481-8216

support@trxstle